

TELESCOPIC CYLINDER
 FRONT MOUNTED COVER - TRUNION
 TIPPING WEIGHT: 49-71 ton / 108-157 x 1000 lbs

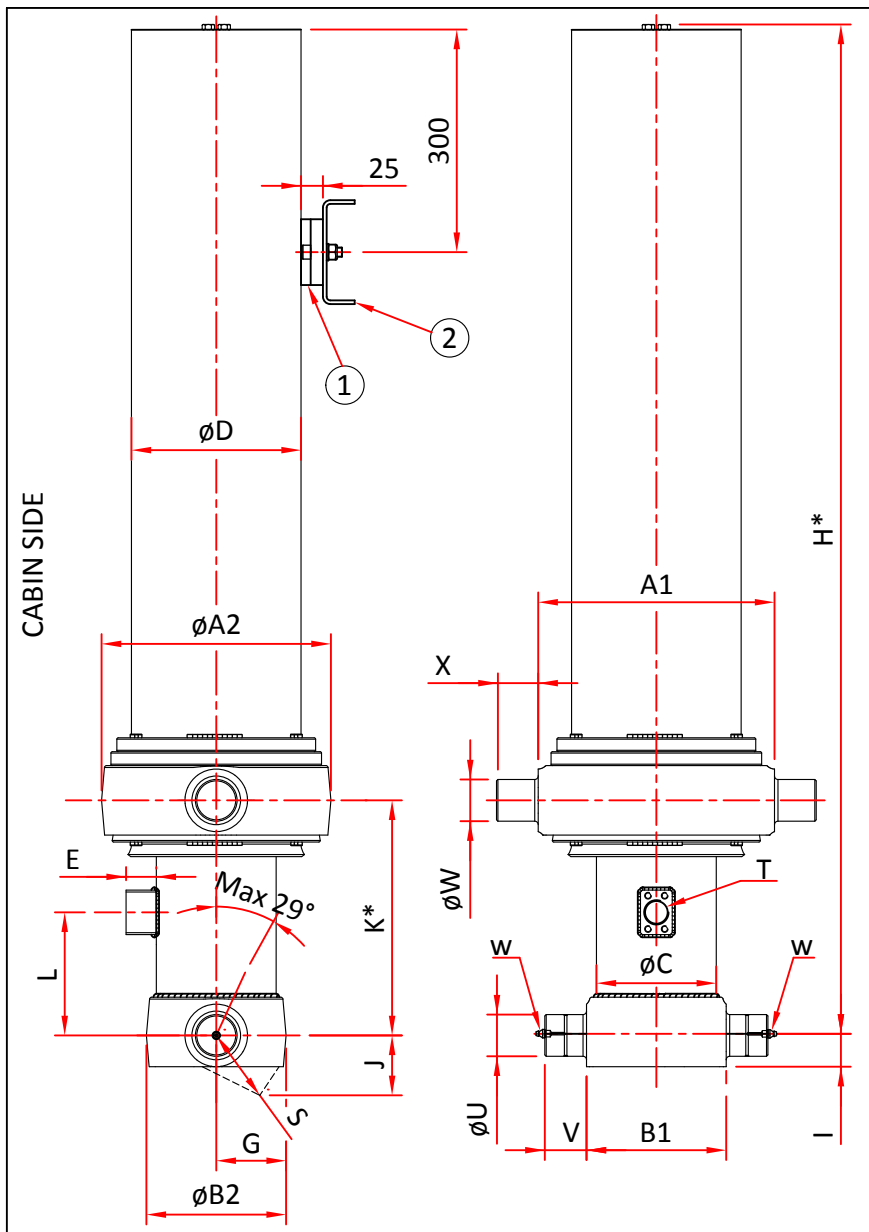

Part Number	Cylinder Type	Stroke Length	Dry Weight of Cylinder	Working Volume	Total Volume	Max. Pressure	Max. Pump Flow	Max. Thrust first stage
10013417C	FMCT 150-3630/3/C	143"	529 lbs	13 gallon	14 gallon	2756 psi	28 gal/min	72752 lbs
		3630mm	240 Kg	50 L	54 L	190 bar	107 L/min	33 ton

Stage	1	2	3	4	5	6	Total
Stage Diameter (inch)	5,9	5,1	4,4				
Stage Diameter (mm)	150	130	111				
Stroke (inch)	47,1	47,8	47,8				143
Stroke (mm)	1198	1216	1216				3630



	U.S.	Metric	Units
A1	13,38"	340	mm
A2	12,99"	330	mm
B1	7,91"	201	mm
B2	7,91"	201	mm
C	6,77"	172	mm
D	9,52"	242	mm
E	1,33"	34	mm
G	3,93"	100	mm
H*	59,29"	1506	mm
I	1,77"	45	mm
J	3,38"	86	mm
K*	13,50"	343	mm
L	7,48"	190	mm
S	4,21"	107	mm
T	1"	1"	BSP
U	2,36"	60	mm
V	2,36"	60	mm
W	2,36"	60	mm
X	2,36"	60	mm

T - Oil Inlet Port
 * incl. 0,79" [-0,2;1,2"] / 20[-5;30]
 pullout on piston

Note :

- > C - Hard Chrome Plated.
- > w - Grease nipple M8x1P - 2 nos. (Base trunion)
- > 20mm Clearance must be maintained between cylinder bottom and cradle or King pin - dimension J=86mm.
- > Anti rattle rubber (1) should be touching the cylinder cover as shown.
- > Bracket (2) to be welded to the head board or head board stiffener.
- > We recommend to use Hypratek Chassis brackets and Lifting brackets.
- > Dimensions subject to change without notice.
- > Please turn over this page to see the mounting instructions and Tipping weight to Tip angle.